

# Stage 20

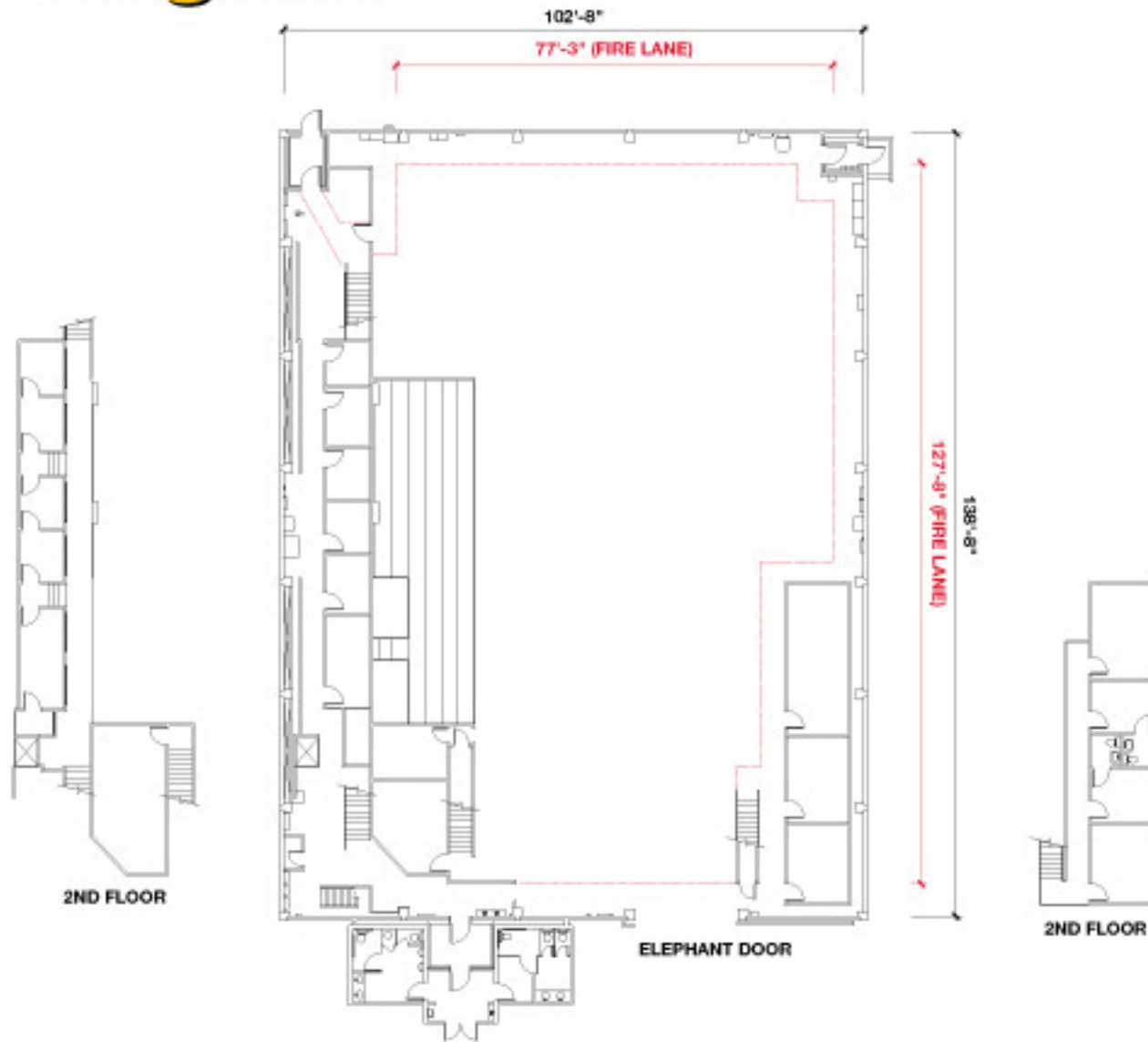

**AUDIENCE RATED  
A-3 MAXIMUM CREW &  
AUDIENCE = 299**

**STAGE SIZE:**  
(102' x 138') 14,076 sq. ft.

**LIVE LOAD CAPACITY OF FLOOR:**  
Wood floor over concrete

**HEIGHT:**  
35' to the permanents with catwalks above

**BUILT-IN ROOMS:**  
7 Dressing Rooms with private restrooms (two handicapped), Hair/Make-up Room, 2 Wardrobe Rooms, 2 Prop Rooms, 2 Set Dressing Rooms, 2 Dimmer Rooms, 2 Sound Booths, Camera Room, 2 AD Rooms, Green Room, Electric Room, Grip Room, Full Crafts Service area

**AUDIENCE CAPACITY:**  
Approx. 185

**FALL PROTECTION:**  
100% Tie-off Horizontal Lifeline system

**ELECTRICAL:**  
D.C. Lighting: 4800 amps  
120 volts

A.C. Prod. Lighting: 4300/1450 amps  
120/208 volts

Basic House/Building Power: 600 amps  
120/240 volts  
Single Phase

AC Spider: 225 amps  
120/240 volts  
Single Phase from  
Basic House Power

Power for Equipment: 3 Phase:  
200 amps  
240 volts\*  
\*Local 40 tie-in required

**ELEPHANT DOORS:**  
One door approximately: 18' Wide x 24' High

**HVAC:**  
Silent air conditioning and heating

**WATER:**  
On four perimeter walls  
Full sink in Crafts Service Area

**FOX STUDIOS  
PRODUCTION SERVICES**  
310.369.2786 / 310.369.4231

\*\* & © 2004 Fox and its related entities. All rights reserved.



**FOX STUDIOS**  
10201 W. Pico Blvd.  
Los Angeles, California 90035  
310.FOX.INFO / (f)310.969.0468  
www.foxstudios.com