

Stage 15

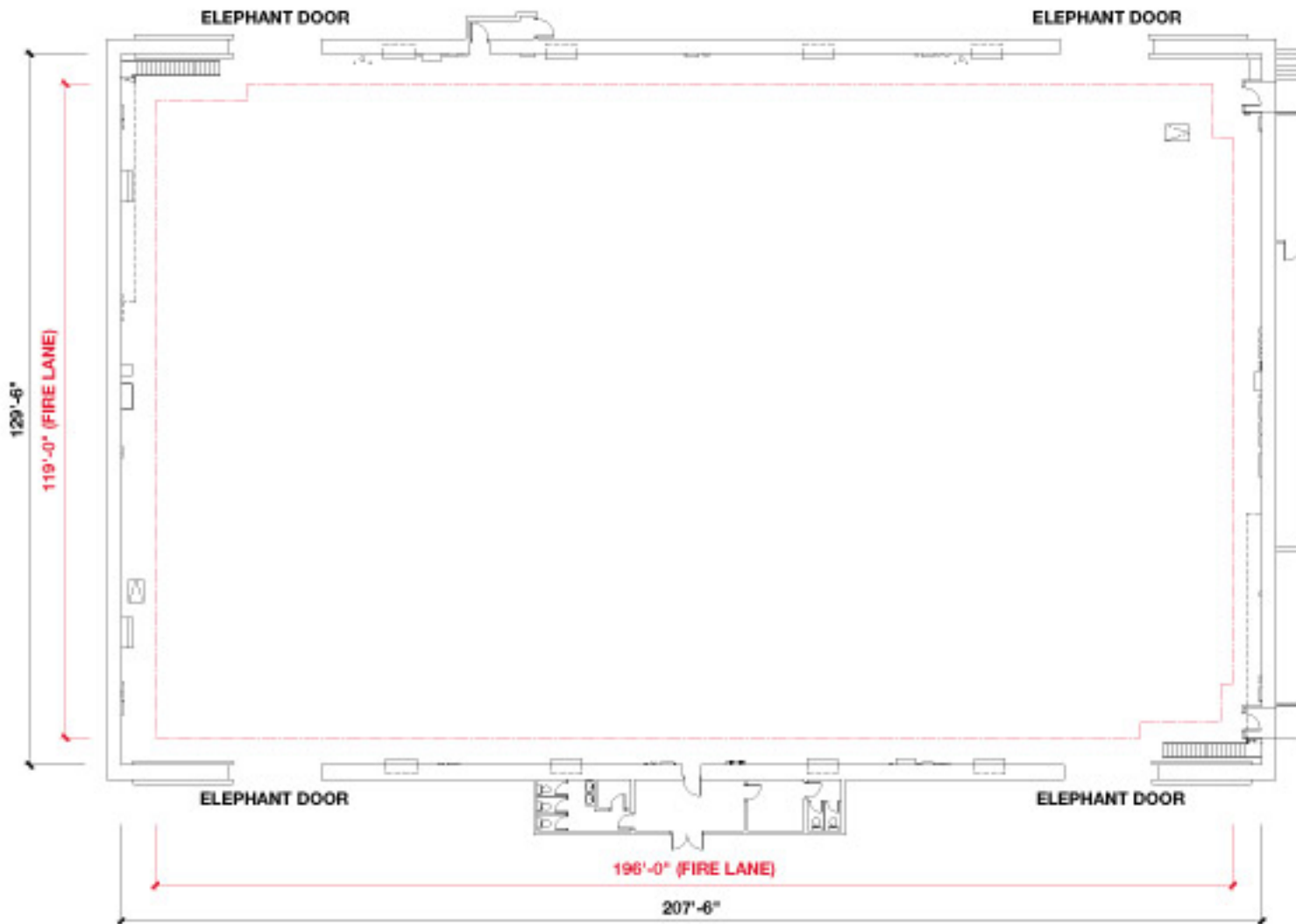

STAGE SIZE:

(130' x 207') 26,910 sq. ft.

LIVE LOAD CAPACITY OF FLOOR:

Uniform Distribution = 250 PSF
 Concentrated on Min. 2' x 2' area = 3500 lbs.
 (Engineered Drawings Available Upon Request)

HEIGHT:

40' to the permanents with catwalks above

FALL PROTECTION:

100% Tie-off Horizontal Lifeline system

ELECTRICAL:

D.C. Lighting: 4800 amps
 120 volts

A.C. Production Lighting: 200 amps
 2400 volts for temporary transformer
 (Max. size transformer 750KVA)
 With a 750KVA transformer:
 6000/2000 amps @ 120/208 volts

Basic House/Building Power: 400 amps
 120/240 volts
 Single Phase

Power for Equipment: 3 Phase:
 200 amps
 240 volts*

*Local 40 tie-in required

ELEPHANT DOORS:

Four entrances each approximately:
 15' 9" Wide x 22' High

HVAC:

Silent air conditioning and heating

WATER:

On four perimeter walls

**FOX STUDIOS
 PRODUCTION SERVICES**
310.369.2786 / 310.369.4231

© & © 2004 Fox and its related entities. All rights reserved.



FOX STUDIOS

10201 W. Pico Blvd.
 Los Angeles, California 90035
 310.FOX.INFO / (f)310.969.0468
 www.foxstudios.com