

# Stage 11

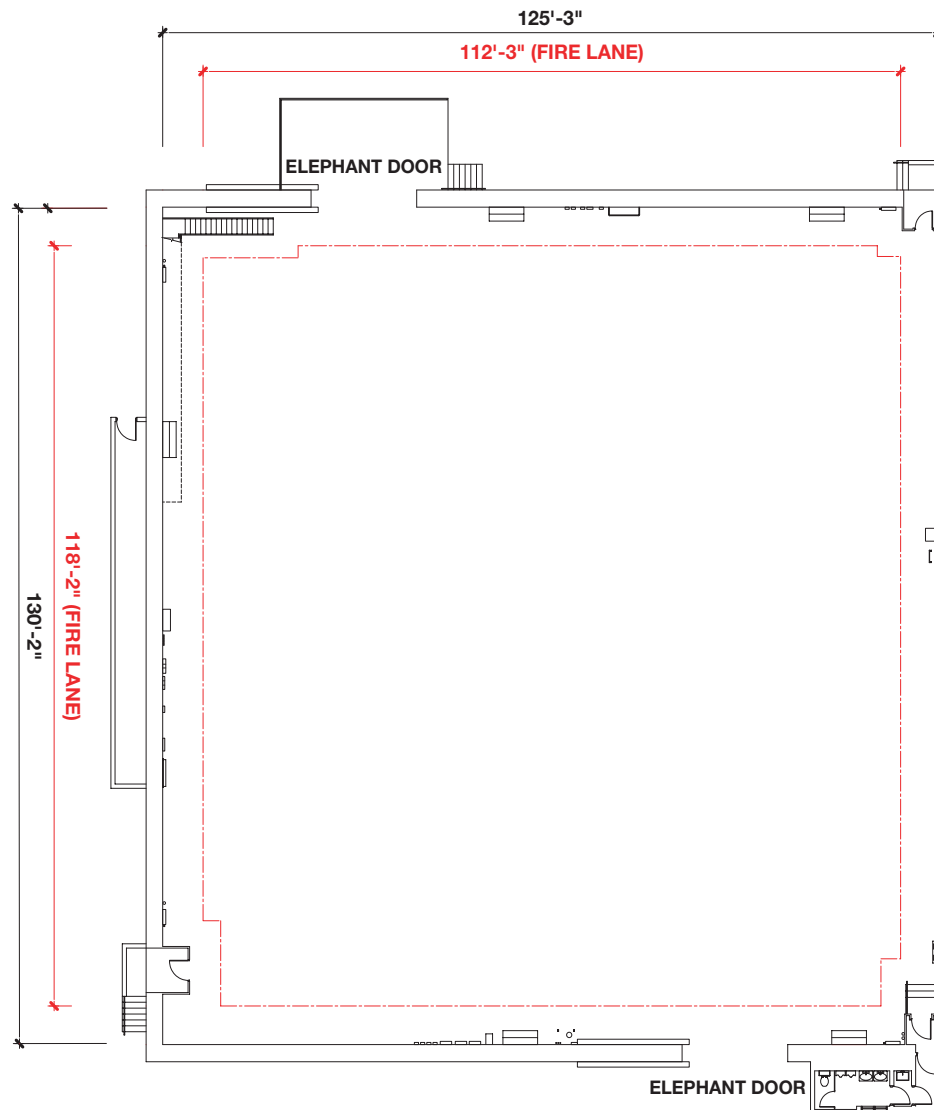

**STAGE SIZE:**  
(130' x 125') 16,250 sq. ft.\*

**LIVE LOAD CAPACITY OF FLOOR:**  
Uniform Distribution = 250 PSF  
Concentrated on Min. 2' x 2' area = 3500 lbs.  
(Engineered Drawings Available Upon Request)

**HEIGHT:**  
40' to the permanents

**FALL PROTECTION:**  
100% Tie-off Horizontal Lifeline system

**ELECTRICAL:**  
A.C. Prod. Lighting: 7200/2400 amps  
Basic House/Building Power: 400 amps  
120/240 volts  
Single Phase

Power for Equipment: 3 Phase:  
200 amps  
240 volts\*\*  
\*\*Local 40 tie-in required

D.C. Lighting: Available upon request

**ELEPHANT DOORS:**  
Two entrances approx:  
16' Wide x 22' High

**HVAC:**  
Silent air conditioning and heating

**WATER:**  
On three perimeter walls

\*Stage Dimensions to be field verified.

Downloadable PDF available at [www.foxstudiosstages.com](http://www.foxstudiosstages.com)

FOX STUDIOS  
PRODUCTION SERVICES  
310.369.2786 / 310.369.4000

™ & © 2010 Fox and its related entities. All rights reserved.



FOX STUDIOS  
10201 W. Pico Blvd.  
Los Angeles, California 90035  
310.FOX.INFO / (f)310.969.0468  
[www.foxstudios.com](http://www.foxstudios.com)