

Stage 10

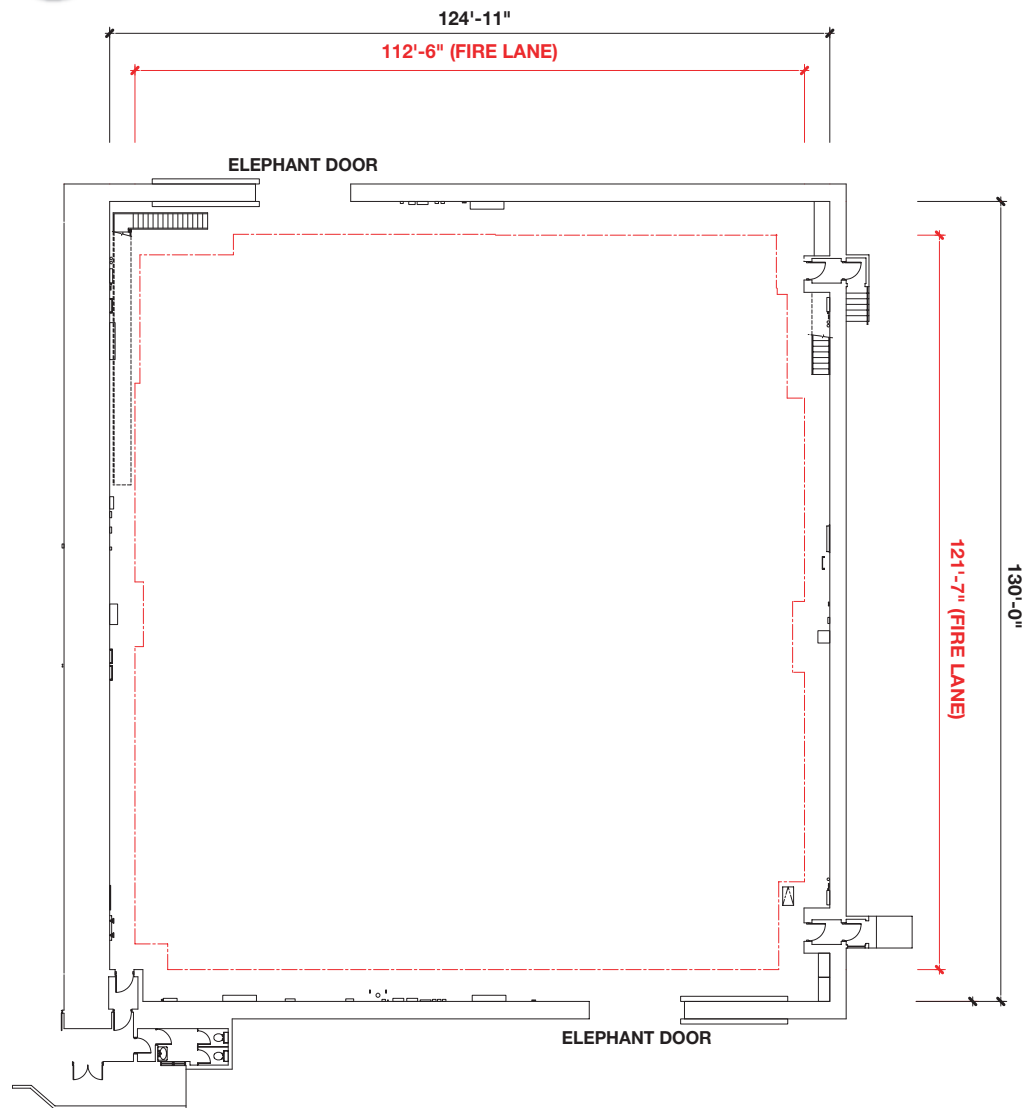

STAGE SIZE:
 (125' x 130') 16,250 sq. ft.*

LIVE LOAD CAPACITY OF FLOOR:
 Uniform Distribution = 250 PSF
 Concentrated on Min. 2' x 2' area = 3500 lbs.
 (Engineered Drawings Available Upon Request)

HEIGHT:
 40' to the permanents with catwalks
 above

FALL PROTECTION:
 100% Tie-off Horizontal Lifeline system

ELECTRICAL:
 A.C. Prod. Lighting: 7200/2400 amps
 Basic Building Power: 400 amps
 120/240 volts
 Single Phase

Power for Equipment: 3 Phase:
 200 amps
 240 volts**
 **Local 40 tie-in required

D.C. Lighting: Available upon request

ELEPHANT DOORS:
 Two entrances approx:
 16' Wide x 22' High

HVAC:
 Silent air conditioning and heating

WATER:
 On four perimeter walls

*Stage Dimensions to be field verified.

Downloadable PDF available at www.foxstudiosstages.com

**FOX STUDIOS
 PRODUCTION SERVICES**
310.369.2786 / 310.369.4000

™ & © 2010 Fox and its related entities. All rights reserved.



FOX STUDIOS
 10201 W. Pico Blvd.
 Los Angeles, California 90035
 310.FOX.INFO / (f)310.969.0468
www.foxstudios.com